

EXTRACTION CHAMBERS

APPROVED TO CATEGORY 4, 400°C - 1/2 hr



VMCM 400 and 700



C4 APPROVED, 400°C - 1/2 h for collective accommodation and ERP - PV
no. RS 02-005 - Rec. 11/2

Range width, VERSION L (single intake)

COMPATIBLE WITH ALL VMC TYPES (self adjusting, humidity controlled
A and B, gas)

LOCAL SWITCH, series mounted

Sealed branch pipe connections for REINFORCED AIR
TIGHTNESS of the network

EASE OF INSTALLATION, internal or external installation

LOW NOISE LEVEL

NATHER

COLLECTIVE ACCOMMODATION

Category 4 approved extraction chambers, 400°C - 1/2 h

VMCM 400 and 700



COLLECTIVE
HOUSING



TERTIARY
BUILDING



COMFORT
AND C4 APPROVED



The VMCM 400 and 700 chambers, approved to 400°C - 1/2 h, are specially designed for the extraction of air flows in collective accommodation and tertiary buildings. They are compatible with any type of VMC: self-adjusting, humidity-controlled (depending on technical recommendation) with or without gas boiler. They allow the requirements of the French New Acoustic Regulations (NRA) (DTU 68.3) to be met.

They are mainly installed in attics or on building terraces.

DESCRIPTION

- Single phase C4 approved extraction chamber, 400°C – 1/2 h
- Easy maintenance with fully removable side panel
- Type L: intake / two position discharge at 90°: side intake / vertical or side discharge

RANGE

2 sizes: VMCM 400 – VMCM 700

Max flow rate in m³/h at 100 Pa.

VMCM 400 jusqu'à 480 m³/h

VMCM 700 jusqu'à 825 m³/h

CONSTRUCTION

- Galvanized steel casing
- Single phase class F motor, outside air flow
- Single inlet centrifugal impulse impeller
- Direct coupled motor / impeller assembly
- Protective flyscreen grill at discharge
- Circular branch pipe connections with seal
- Series mounted local switch
- Fixing lugs and Ø 8 mm holes for suspension by threaded rods
- Motor access hatch

Standard accessories



Local switch provides local isolation during maintenance operations



Branch pipes with seals provide reinforced airtightness for the network connection

INSTALLATION

- Internal (attics, false-ceiling, equipment room, etc) and external installation without additional accessories
- Multi-position
- On the ground on anti-vibration mountings or mounted on hangers

141

Prices
p 145

COLLECTIVE ACCOMMODATION

Category 4 approved extraction chambers, 400°C - 1/2 h

VMCM 400 and 700

DIMENSIONS

VERSION L

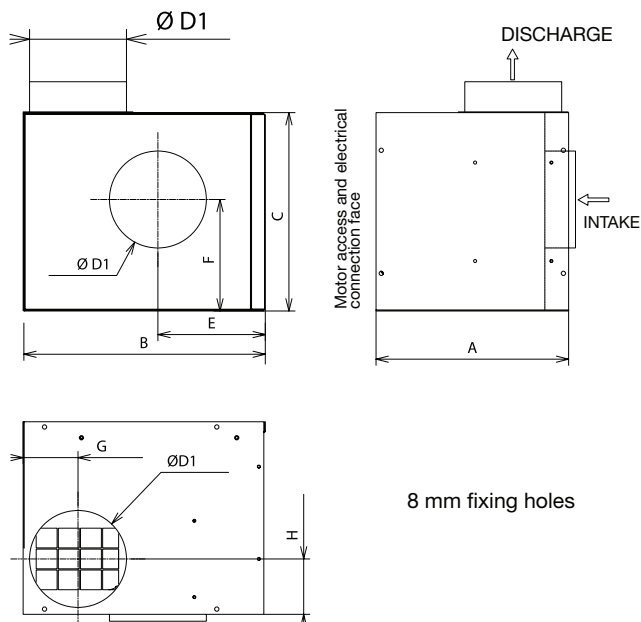

	A	B	C	ØD1	E	F	G	H	Weight (kg)
VMCM 400	313	394	323	160	174	182	90	92	12
VMCM 700	390	458	367	250	192	202	138	140	16

VENTILATION AND POWER CONSUMPTION FEATURES

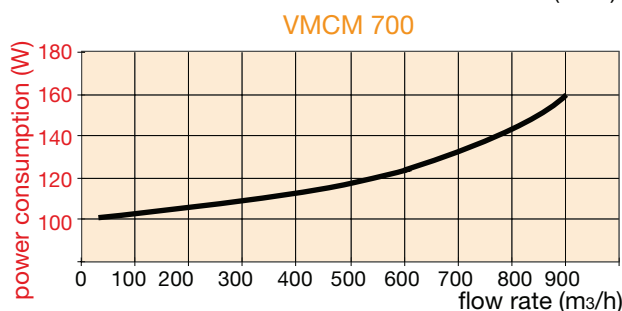
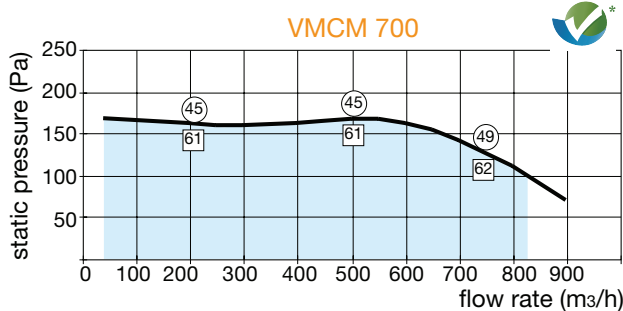
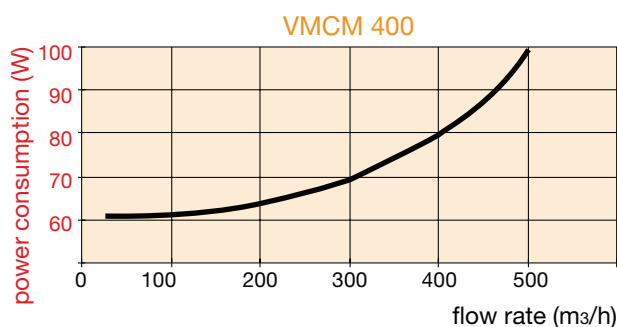
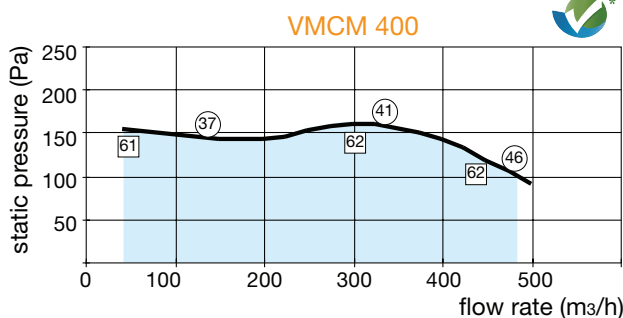

□ operating range for humidity controlled CMV

○ Sound pressure level in free air at 4 m, Lp in dB (A) intake connected
 □ Radiated acoustic power level in the duct, Lw in dB(A)

€* The products marked with this logo comply with the performance display recommendations defined by Uniclimate.

COLLECTIVE ACCOMMODATION

Category 4 approved extraction chambers, 400°C - 1/2 h

VMCM 400 and 700

ELECTRICAL FEATURES

	VMCM 400	VMCM 700
impeller type	action	action
impeller	160/62	170/68
motor power (W)	40	110
power supply	230 V -1Ph - 50 Hz	
nominal current (A)	0.48	1
rotation speed (rev/min)	1300	1300
capacitor (uF)	1.5	5

ACCESSORIES

Connection accessories



Flexible sleeve (400°C – 2 h) avoids any transmission or residual vibrations from the unit to the duct system.



Galvanised steel rigid sound trap situated on the inlet, reduces transmission of any sound to the system.

Speed variation (except collective)



Single phase electronic speed controller allows the fan to be varied from 50 % to 100 % of its nominal flow rate, with on/off function.



Single phase autotransformer unit allows 4 or 5 different operating flow rates to be obtained depending on the voltages delivered, with on / off function.

Optional accessories



Anti-vibration mounts avoid the transmission of any vibrations from the unit to its environment.



Thermo-magnetic circuit breaker provides local isolation and thermal protection for the motor.



Pressure sensor kit indicates the unit's operating status by measuring its depression with information feedback. Factory fitted, it can be installed later in the kit version (installation compliance upgrade).

Gas pressure sensor, compulsory for gas CMV, it indicates the unit's operating status by measuring its depression with information feedback. It is factory fitted.



Backup motor / impeller set sometimes necessary to respond to requirements in terms of after sales service response times.